

# FARMINGTON HILLS CORPORATE CAMPUS BUILT TO SUIT

TWO BUILDINGS | UP TO 300,000 SF

SITE PLAN AND BUILDINGS FULLY APPROVED

**KOJAIANO**



# FARMINGTON HILLS CORPORATE CAMPUS - BTS



## ABOUT

- LOCATED AT 12 MILE ROAD & INVESTMENT DRIVE
- IN THE FARMINGTON HILLS CORPORATE CAMPUS
- TWO B-T-S OPTIONS
  - BUILDING "A" 150,000 GSF
  - BUILDING "B" 150,000 GSF
- SITE AREA: 28.59 ACRES
- ZONING: PUD

## PARKING

- TOTAL PARKING SPACES: 848
- TOTAL LAND BANKED SPACES: 132
- TOTAL SPACES PROVIDED: 980

## SIGNAGE

- PRE-APPROVED PYLON SIGNAGE ALONG 696 (●)
- BUILDING SIGNAGE AVAILABLE
- MONUMENT SIGNAGE AVAILABLE



# FARMINGTON HILLS CORPORATE CAMPUS - BTS



## AERIAL

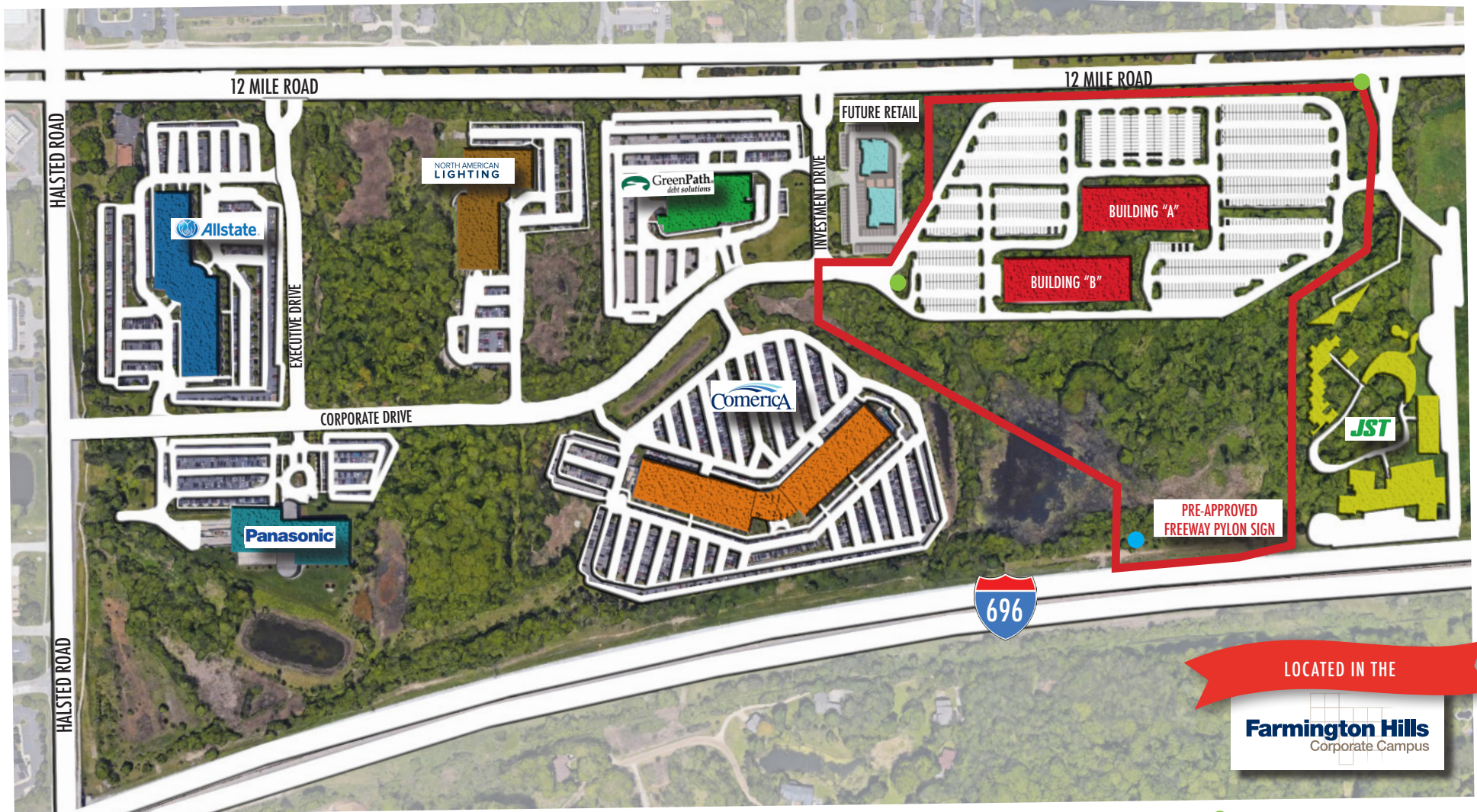

LOCATED IN THE  
**Farmington Hills**  
Corporate Campus

● MONUMENT SIGNAGE

FOR MORE INFORMATION

DAN LEPPINK | VICE PRESIDENT - LEASING | DIRECT: 248.644.7600 | EMAIL: DLEPPINK@KOJAIAN.COM

# FARMINGTON HILLS CORPORATE CAMPUS - BTS

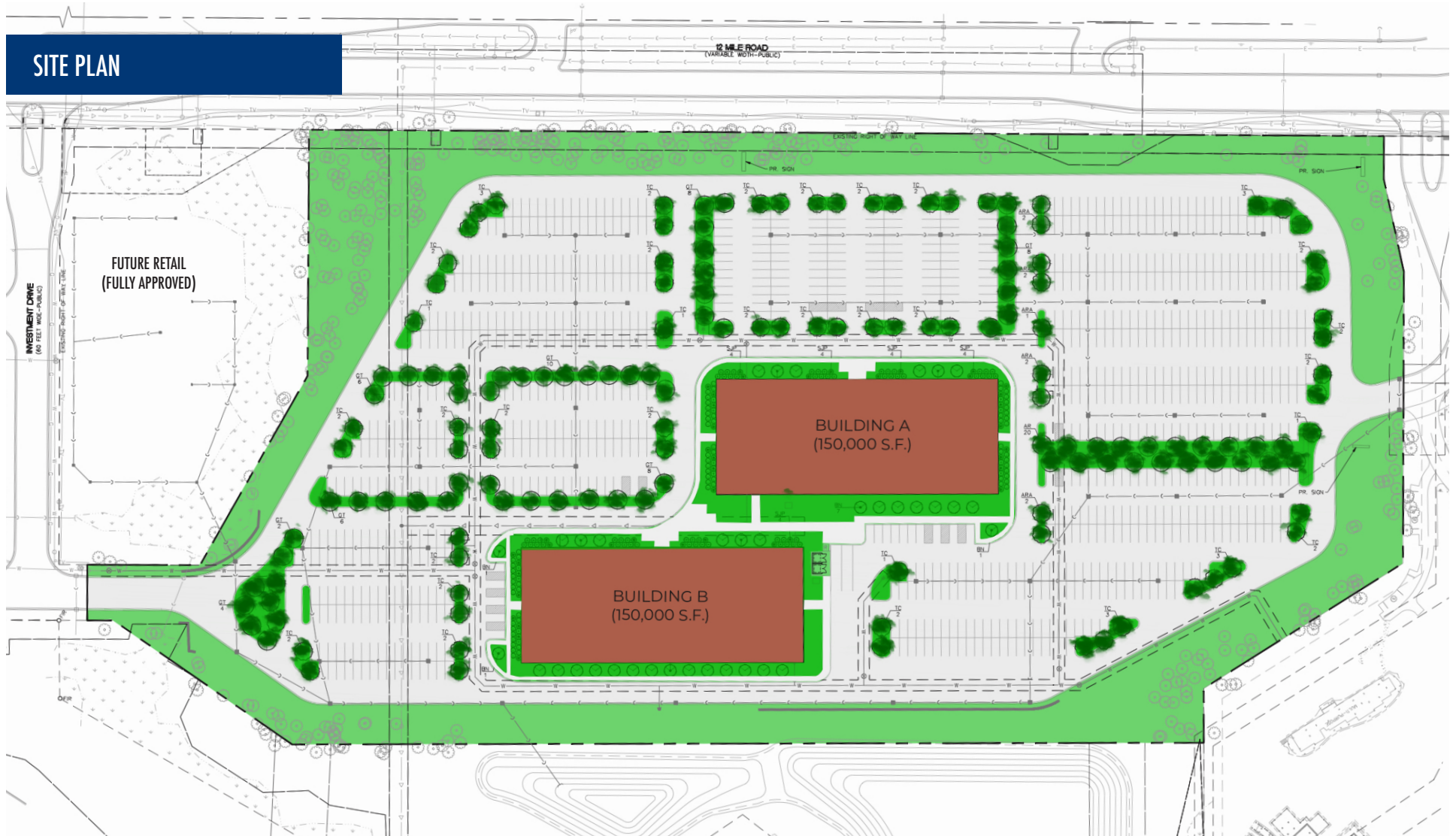

FOR MORE INFORMATION

DAN LEPPINK | VICE PRESIDENT - LEASING | DIRECT: 248.644.7600 | EMAIL: DLEPPINK@KOJAIAN.COM

## GROUND FLOOR PLAN

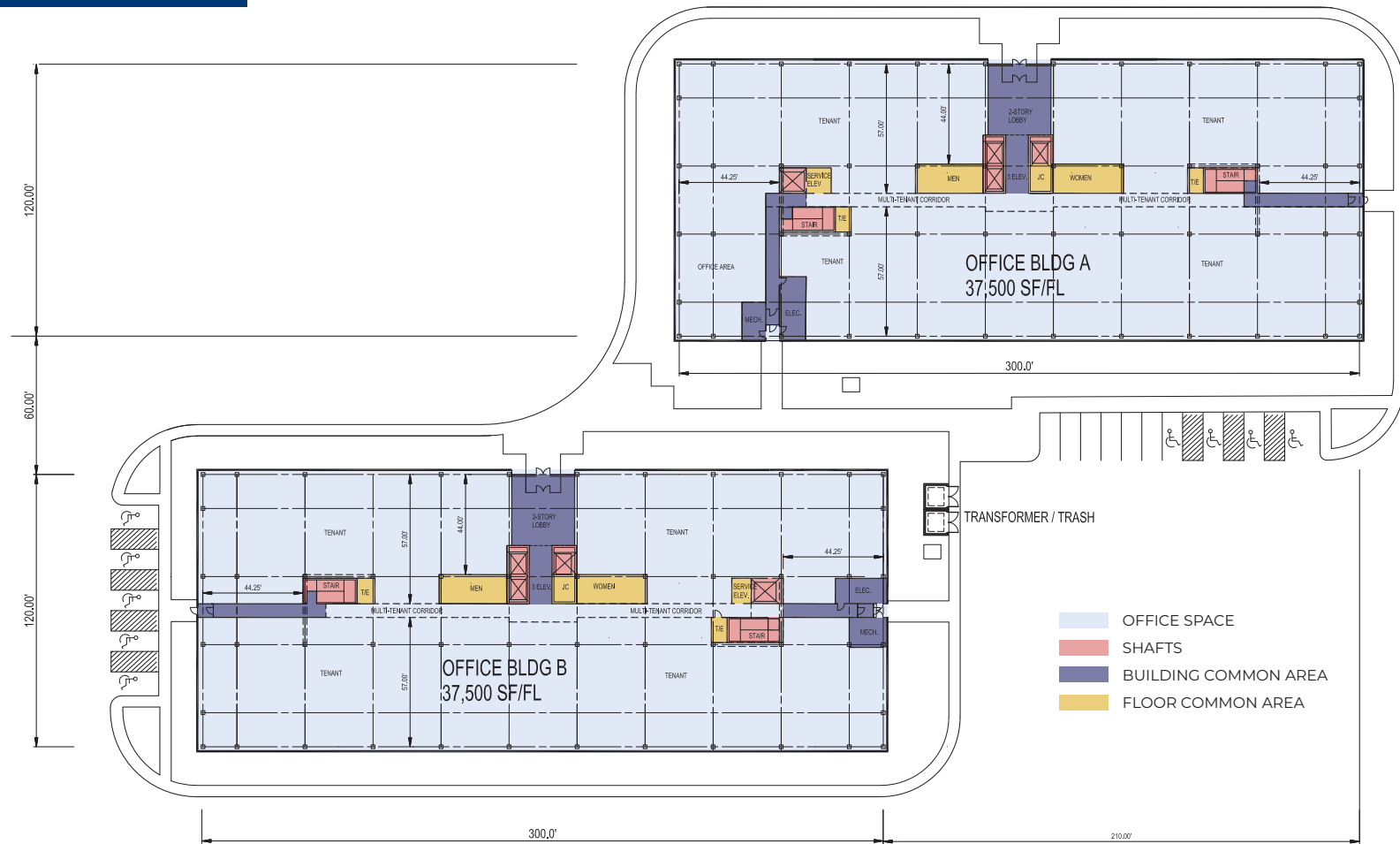

## TYPICAL FLOOR PLAN (2-4)

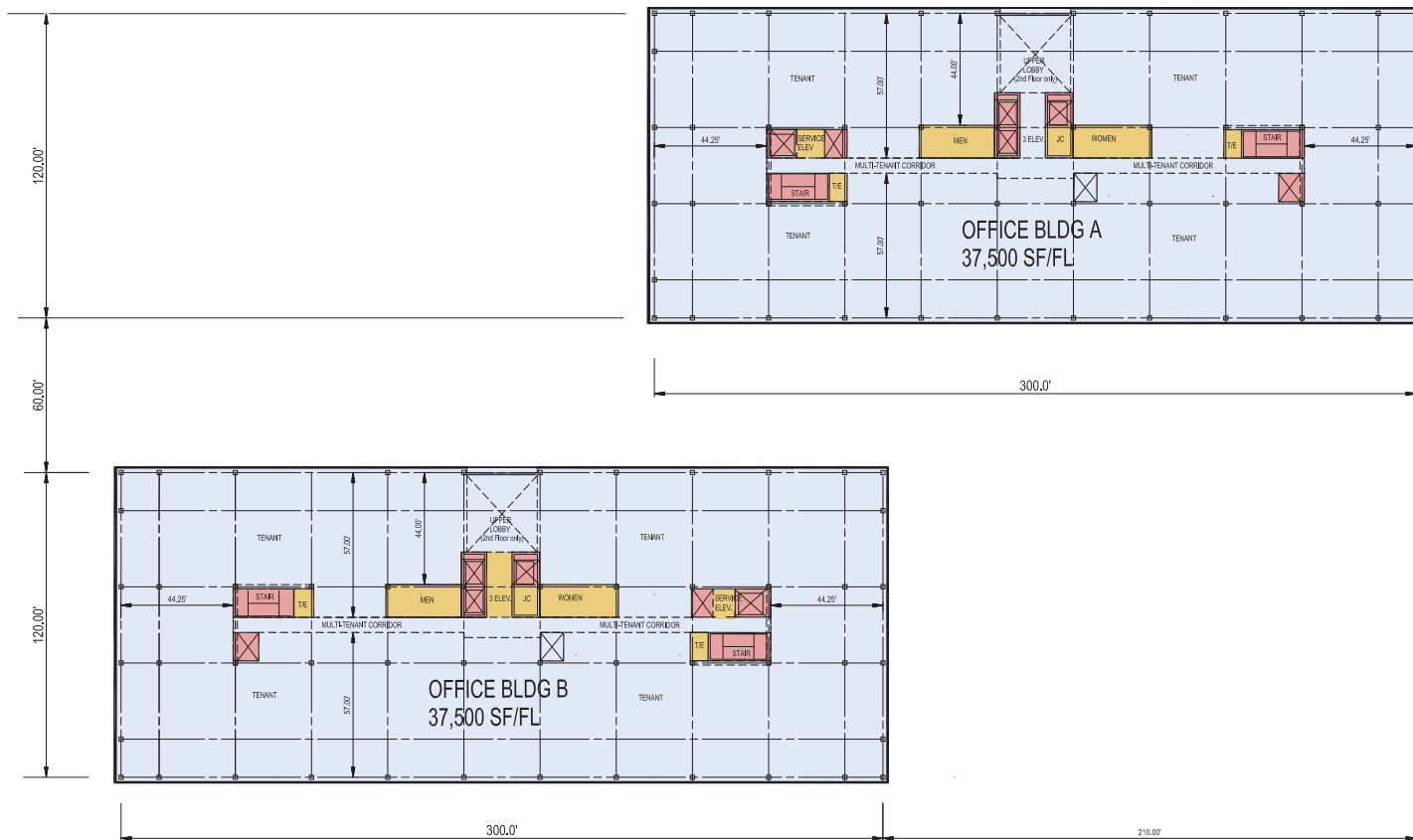

# FARMINGTON HILLS CORPORATE CAMPUS - BTS



## SOUTH ELEVATION



FOR MORE INFORMATION

DAN LEPPINK | VICE PRESIDENT - LEASING | DIRECT: 248.644.7600 | EMAIL: [DLEPPINK@KOJAIAN.COM](mailto:DLEPPINK@KOJAIAN.COM)

# FARMINGTON HILLS CORPORATE CAMPUS - BTS



## EAST ELEVATION



FOR MORE INFORMATION

DAN LEPPINK | VICE PRESIDENT - LEASING | DIRECT: 248.644.7600 | EMAIL: [DLEPPINK@KOJAIAN.COM](mailto:DLEPPINK@KOJAIAN.COM)



# FARMINGTON HILLS CORPORATE CAMPUS - BTS



## EAST ELEVATION



FOR MORE INFORMATION

DAN LEPPINK | VICE PRESIDENT - LEASING | DIRECT: 248.644.7600 | EMAIL: [DLEPPINK@KOJAIAN.COM](mailto:DLEPPINK@KOJAIAN.COM)

# FARMINGTON HILLS CORPORATE CAMPUS - BTS



## SOUTHEAST ELEVATION



FOR MORE INFORMATION

DAN LEPPINK | VICE PRESIDENT - LEASING | DIRECT: 248.644.7600 | EMAIL: [DLEPPINK@KOJAIAN.COM](mailto:DLEPPINK@KOJAIAN.COM)

# FARMINGTON HILLS CORPORATE CAMPUS - BTS



## AREA AMENITIES

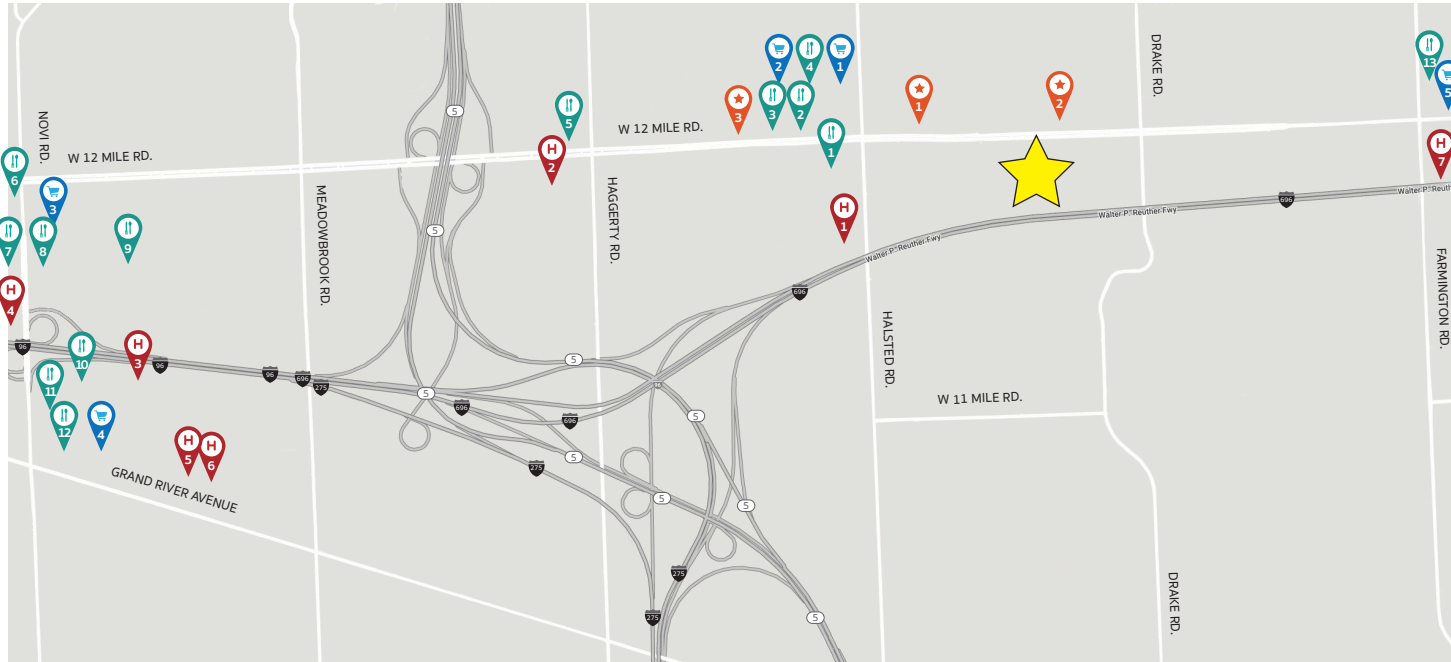

### RESTAURANTS

- |                              |                                       |
|------------------------------|---------------------------------------|
| 1. Savvy Sliders             | 10. Red Robin                         |
| 2. Kerby's Koney             | 11. Olive Garden                      |
| 3. Panera Bread              | 12. Famous Dave's                     |
| 4. Antonio's Cucina Italiana | 13. Panda Express                     |
| 5. 2 Booli                   | 14. Primanti Bros. Restaurant and Bar |
| 6. Thai Basil                | 15. Bonefish Grill                    |
| 7. Starbucks                 | 16. Potbelly                          |
| 8. Starbucks                 | 17. Masala Indian Kitchen             |
| 9. Carrabba's Italian Grill  | 18. QDOBA Mexican Eats                |
| 10. Genji Novi               | 19. Tim Hortons                       |
| 11. Red Lobster              | 20. La Kabob Mediterranean Cuisine    |
| 12. Chick-fil-A              | 21. Leo's Coney Island                |
| 13. Cheesecake Factory       |                                       |
| 14. California Pizza Kitchen |                                       |



### RETAILERS

1. Kroger
2. CVS
3. Twelve Oaks Mall
4. Macy's
5. JCPenney
6. Nordstrom
7. Novi Town Center
8. Ulta Beauty
9. Walmart
10. T.J. Maxx
11. Heartland Marketplace
12. Hallmark
13. Abode Furniture



### HOTELS

1. Mainstays Suites
2. Holiday Inn Express and Suites
3. DoubleTree by Hilton
4. Four Points by Sheraton
5. Sonesta Select
6. Sonesta Simply Suites
7. Courtyard by Marriot



### CHILDCARE

1. Childtime
2. Great Beginnings Day Care Center
3. KinderCare Learning Center

## ABOUT KOJAIAN COMPANIES

Our genuine desire to produce exceptional properties began in the 1950's when (the late), Mike Kojaiian, president and founding principal, engaged in his first real estate undertaking, with the understanding "there is no substitute for quality."

While the company has grown and expanded, the message has remained the same ... uncompromised quality in every detail.

Today, this commitment to quality still guides our companies and is evident in our strong track record of performance and satisfaction. Our properties span the complete real estate spectrum, including office buildings, industrial buildings and parks, research and development centers, and retail facilities.

The common thread linking this diversity is that each project will stand out for its aesthetic contribution to its respective market and the environment it provides. The Kojaiian Companies have been involved in the acquisition and ownership of 100 million square feet of real estate covering markets throughout the United States.

Please contact us any time for a personal tour of any of our buildings.

Tony Antone  
Executive Vice President  
tantone@kojaian.com

Chris Kojaiian  
Senior Vice President  
ckojaiian@kojaian.com

Dan Leppink  
Vice President - Leasing  
dleppink@kojaian.com

## ABOUT KOJAIAN COMPANIES

### RECOGNIZED NATIONWIDE AS A ONE OF THE LEADING COMMERCIAL LEASING EXPERTS

Our portfolio is comprised of more than 100 million square feet of Class-A office, commercial and industrial space that is strategically located, architecturally distinct and technologically equipped to meet your needs. With our well-respected in-house brokers, we offer cost-effective operation and management of our properties to ensure your needs are our main focus. That is why fortune 500 companies turn to us to deliver the highest quality properties within the context of a trusted, value-driven relationship.

